



SHO Lighting



Engine-Generator



Heavy-Duty Enclosures



Captive Tower Latch



Forklift Pockets



SHO Lighting System



*Reliability,
performance,
and integrity
backed by over
60 years of
experience.*



ALLMAND NIGHT-LITE™ PRO SERIES Value Added Features:

- **SHO (super high output) lighting system which utilizes parallel lamp fixtures** is more efficient than competitive lighting systems and provides up to 50 percent more light output. In addition, the optional Saf-T-Visor™ attachment directs up to 13.5 percent of previously wasted skyward light to the work site.
- **Engine-generator package** includes an 1800 rpm liquid-cooled diesel engine coupled to a 6-kw generator. Engine requires oil changes at 200-hour intervals. Indirect injection provides low engine noise level.
- **Heavy-duty enclosure with corrosion- and dent-resistant molded fenders, 12-gauge fold-up doors and 10-gauge side panels** provide necessary ruggedness to meet the demands of the job site.
- **Captive tower latch and self-locking stabilizers** eliminate need for troublesome pins.
- **Forklift pockets and lifting eye** allow easy loading and unloading of up to 12 units on a flatbed truck.
- **Molded polyethylene fuel tank** reduces the chance of contamination from rust and corrosion associated with metal. The 30-gallon capacity provides approximately 65 hours of continuous operation.

SPECIFICATIONS

Dimensions

Height (mast lowered): 6 ft. 1 in. (1.85 m)
 Height (mast raised): 30 ft. (9.14 m)
 Length (with fixtures): 13 ft. 6 in. (4.04 m)
 Width: 4 ft. 1.5 in. (1.26 m)
 Outrigger width: 7 ft. 9.5 in. (2.37 m)
 Wheels and tires: 13 in.

Engine

Standard: Kubota D905 BG, 1800-rpm liquid-cooled diesel with 12-volt electric start
 (Optional: Perkins 103.10, 10.7 hp, 1800-rpm diesel engine)
 Displacement: 54.86 cu. in. (898 cc)
 Alternator: 30 amp, 12-volt
 Power output: 10.5 hp
 Fuel: Diesel
 Fuel consumption: .46 gal/hr (1.7 L/hr) @ 73 percent load
 Fuel capacity: 30 gal. (114 L)
 Oil sump capacity: 5.4 US qt. (5.1 L)
 Low oil pressure, high temperature automatic shut off
 Glow plug cold start system

SHO Lighting

Lamps: Four 1000-watt metal Halide HID mounted in Allmand's exclusive SHO parallel lamp fixtures

Electrical

Alternator: 6.0 kw, 60 Hz, 1 phase
 Circuits: Hard-wired electrical
 Ballast: Easily-serviceable, "componentized" assemblies
 Ground rod
 120-volt convenience outlets

Tower

Assembly: Heavy-duty, three section tower
 Guide pads: Self-lubricating nylon
 Light bar: 360 degree rotatable from the ground

Trailer

Frame: Formed, welded steel
 Enclosure: Heavy duty with 10-gauge side panels and 12-gauge hood and lockable lift-up doors
 Fenders: Molded, polyethylene rust- and dent-resistant

Hitch: Two-inch ball
 Lights: Stop, turn and running
 Tie-down rings

Stabilizers

Three-point outrigger design
 Tower center-mounted between two retractable rear outriggers and tongue jack
 Remains operational in wind gusts up to 65 mph (104.59 kph)

Domestic Shipping Weight

Light fixtures: 15 lbs. per fixture
 Trailer and mast: 1540 lbs.
 Total weight: Approx. 1600 lbs.

Available Options

Cushion-mounted light fixtures
 Saf-T-Visor™
 Pintle hitch
 Sound attenuation package
 Electric tower winch
 8-kw generator

Allmand Brothers Inc.—helping build America for more than half a century

Since 1938, Allmand products have been making construction sites brighter, warmer, safer and more efficient. The Allmand portable light towers have set the standard for the industry for over 45 years, providing the most powerful lighting systems in their class. No comparable portable light tower can match the Allmand SHO Lighting System.

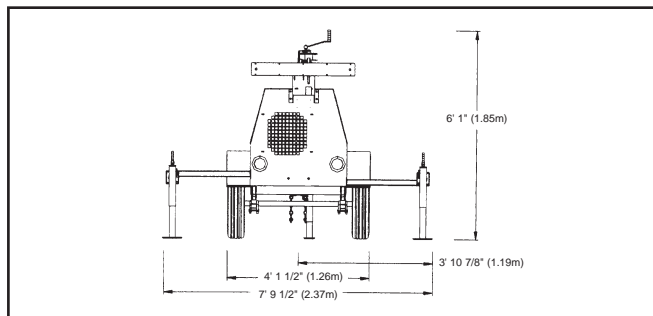
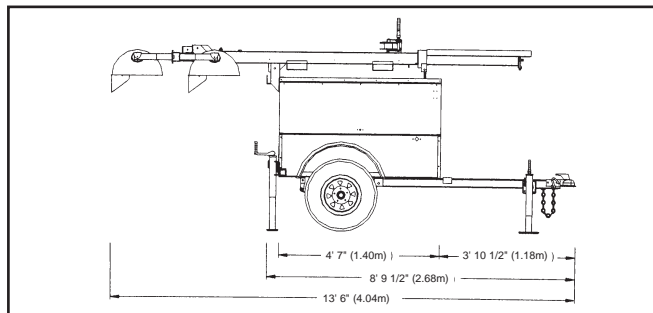

Specifications are subject to change without prior notice.



Steve and Roger Allmand. Same family. Same ownership, since 1938.



Allmand Bros. Inc.
 P.O. Box 888
 Holdrege, NE 68949
 800-562-1373
 308-995-4495
 Fax: 308-995-5887
 www.allmand.com

Sold and serviced by: